

THE HOOD SCOOP

GATEWAY

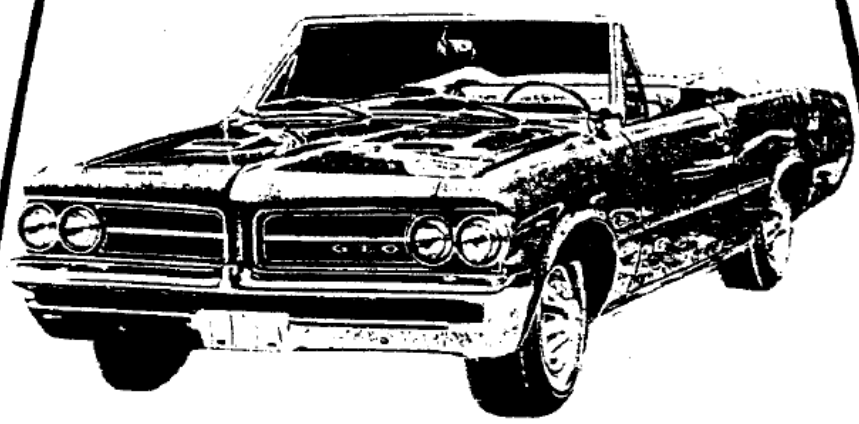
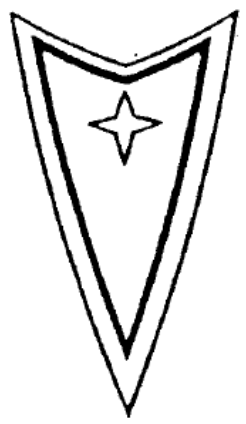

GTO

ASSOCIATION

ST. LOUIS, MISSOURI

GATEWAY GTO ASSOCIATION OFFICERS

President.....Darrell Carnal (314)928-8030
1458 Arapahoe Way
St. Charles, MO 63303

Vice President, MO..John Novelli (314)653-1051
2058 Siesta
St. Louis, MO 63138

Vice President, IL..Will Bowers (618)288-4187
24 Sierra Drive
Glen Carbon, IL 62034

Treasurer.....Earl Chapman (314)282-2203
5000 Country Ridge Dr.
Imperial, MO 63052

Secretary.....Sandy Chapman

Chapter GTOAA Rep...Rich Vie (314)426-2709
10835 Lacklink
St. Louis, MO 63114

NEWSLETTER CONTRIBUTORS

Tony Bezzole.....(314)878-6892
Will Bowers.....(618)288-4187
Earl Chapman.....(314)282-2203
Ron Fiebiger.....(314)892-4712
Steve Hedrick.....(314)296-7559
John Novelli.....(314)653-1051
Rich Vie.....(314)426-2709

The Gateway GTO Association newsletter is published monthly as an informative news bulletin to keep our members up to date on past, current and future events. Classified Ads are free to all members. All articles and classified ads should be submitted to Tony Bezzole before the 15th of the month.

Gateway GTO Association meetings will be held monthly. Dates, times and locations will be announced in the newsletter and on the Gateway GTO Association Hotline, 4-GREAT-1.

SCOOP FROM THE PREZ

1990 is now history! We had an overall good year with our activities, and I wish to personally thank Rich Vie and all those who made it happen.

Looking ahead, 1991 holds great potential for being among the best. We've proven that already with the January Custom Auto Show at the Cervantes Convention Center. Despite all the bad weather, the Gateway GTO's dazzled the public, afflicted with a severe case of cabin fever, showing them that we can be successful in everything we do, through team effort.

My sincere appreciation goes out to everyone who contributed to the display with cars, props and time. We couldn't have done it without support from everyone. Let's make it even bigger and better next year! I'm seeing a dynamic club spirit from our members and we've got the makings of a huge success in all that we attempt. Let's make this year one to remember. We've got the BEST! Let's flaunt it!

The Gateway GTO Association Hotline is now in service. This hotline is for use by members and all other people interested in the association. The purpose of the hotline is to be a quick and easy source of information for future meetings, events, etc. The recorded message on the hotline will be updated as often as necessary (usually weekly). Also, callers can leave a message such as a cruise night that they would like to attend. These messages will be incorporated into the recorded message the next time it is updated. Remember, the number is 4-GREAT-1, (314)447-3281.

Last, but certainly not least, I've just been informed of a new little GTO'er in our club. Dan and Deb Shabel are the very proud parents of a baby boy. His name is Kevin John, he was 6 lbs. 15 oz., born at 8:01 PM on February 10, 1991. Congratulations Dan and Deb!

Darrell

MARCH 1991 GATEWAY GTO ASSOCIATION MEETING

The March meeting will be March 7 at 7:00 PM. It will be held at Tony Bezzole's house. All are encouraged to attend. A map to Tony's house is below. If you have any questions, call Tony at (314)878-6892.

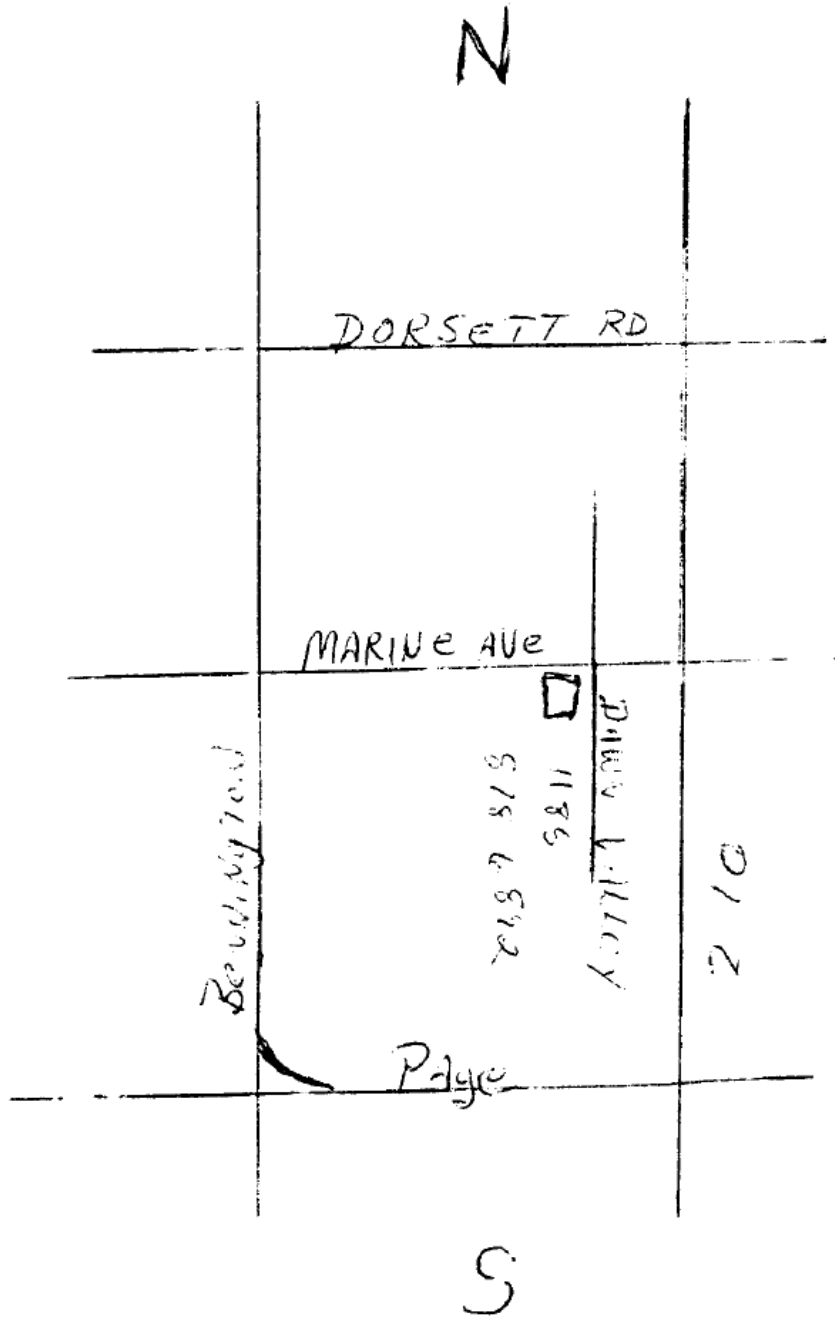

ISCA CAR SHOW



The above picture pretty much tells it all about the ISCA Car Show on January 19th & 20th at the Cervantes Convention Center. The GTO's came in force, and the GTO's left with the trophies. The Gateway GTO Association display had eight GTO's entered. Earl Chapman (65 hardtop), Erik Hackett (69 hardtop), Vic & Joyce Nettle (70 hardtop), and Rich Vie (74 coupe) all entered the display only class. The other four GTO's entered in the competition and all went away winners! In the picture above from left to right are Dave Kries (68 convertible) 1st place, Ray Mersch (70 hardtop) 1st place, Phil Haxel (68 convertible) 3rd place and our President, Darrell Carnal (67 hardtop) 2nd place. The beautiful GTO sign was furnished by Kevin Frigerio. Pat Taylor is supporting the sign and backing up the winners. Congratulations to all!

UPCOMING EVENTS

MARCH 31: EASTER IN THE PARK CONCOURSE DE ELEGANCE

Chairman: Gene Luning, 532-2169
Sponsor: Automobile club of Missouri
Where: Muny Opera Forest Park
Show cars: Pre registered \$8.00, show day
\$15.00 (1966 & older)
Display cars: Pre registered \$6.00, show day
\$12.00 (up to 1976)

Everyone participating will receive a silk screen artist rendition poster. The Easter show is the season kick off and always proves very interesting. Cars at this show are some of the Horseless Carriage Club's finest. Get there early for good parking, upper lot opens 8:00 AM.

The St. Louis Street Rod Association will hold the custom show on the lower lot. Pre register \$7.00, show day \$10.00. For information call 776-3193.

APRIL 7: APRIL FOOLS SWAP MEET CAR SHOW AND CAR CORRAL

Swap meet: call Jack (618)398-5369, advanced
\$10.00, otherwise \$15.00
Car show: call Jean (618)234-0310, \$10.00
Car corral: call Dennis (618)632-8521

This is one of the largest swap meets in the area and where many deals are found. It is held on the Monroe Country Fairgrounds in Waterloo, IL. To get there, take hwy 255 to rt. 3, south to rt. 156 west, 1.5 miles and you are there.

APRIL 14: MUSEUM OF TRANSPORT CAR SHOW

APRIL 20: DON DARR PONTIAC CAR DISPLAY

More information soon!

CALENDAR OF EVENTS

- March 7 Monthly GTO meeting, 7:00 PM, Tony Bezzole's house.
- March 31 Easter Car Show, Forest Park
- April 15 Museum of Transport Car Show
- April 20 Don Darr Display - Club Event
- May 4-5 Muscle From the Past Drag & Show, Gateway International - Club Event
- May 11 Behlmann Car Show
- May 19 O'Fallon Car Show - Club Event
- June 19-23 GTOAA Nationals, Louisville, KY Club Event
- July 10-14 POCI Nationals
- Aug. 2-4 Nostalgia Drag Race & Rod Run Gateway International - Club Event
- Sept. 15 GTO Picnic - Maryland Heights
- Oct. ? GTO vs. Ford Drag
- Oct. ? Wine Run - Club Event
- Dec. ? Gateway GTO Association Christmas Party
- Jan. ? Cervantes Convention Center Custom Auto Show - Club Event
- Club Event - All members are encouraged to attend and participate

1968-1970

LOCATION OF MOUNTING FOR HOOD TACH

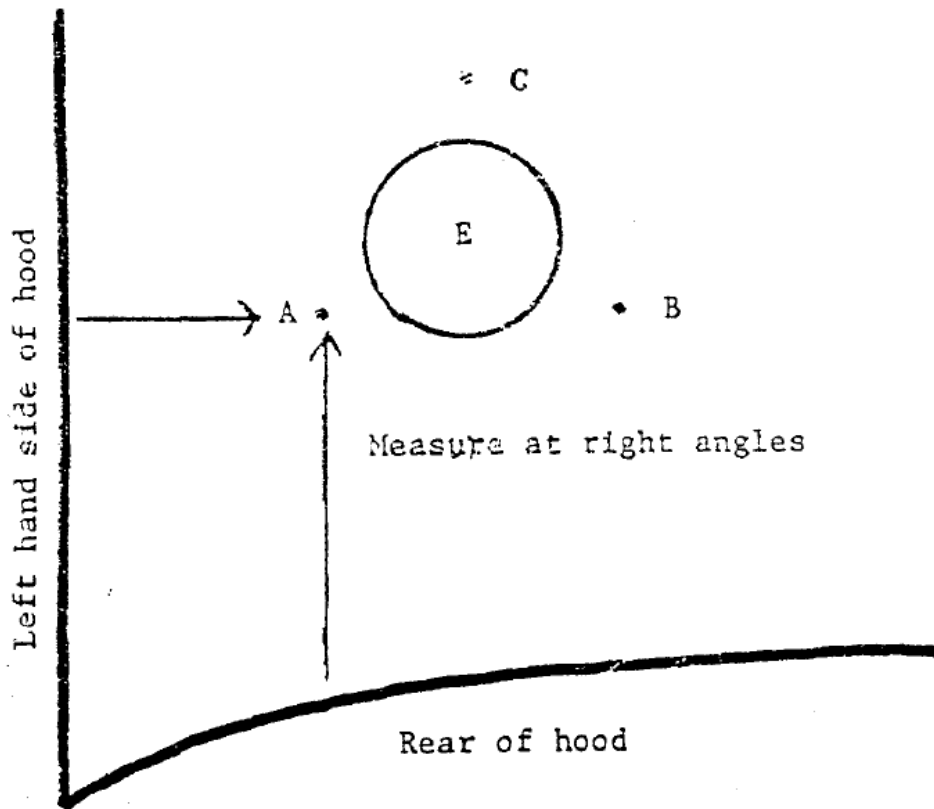

E is 3.50" diameter hole, center of which is 9.75" from left side of hood and 13.125" from back of hood

A, B, and C are .218" diameter holes

A is 7.438" from left side and 12.875" from rear

B is 11.875" from left side and 12.375" from rear

C is 9.625" from left side and 16.625" from rear

After cutting hole E with a hole saw, check your markings and measurements before drilling the stud holes.

The hood tachs used a thin rubber gasket underneath them from the Factory. This type gasket material is easily obtained in sheet form. You can use this in a 1/32" thickness or a 1/64" thickness if the 1/32" sets the tach too high off of your hood. This gasket will assist in keeping water from getting under the tach and entering the tach where the Factory silicone sealer has deteriorated or is not fully sealing the two halves. In addition, Do Not tighten the nuts too tightly as they will cause low spots in the top of the tach from overtensioning of the plastic.

1991 GTO CLUB ROSTER

* Darrell Carnal 1458 Arapahoe Way St. Charles, MO 63303 928-8030 (67)	* Earl Chapman 5000 Country Ridge Drive Imperial, MO 63052 282-2203 (65)	* John Novelli 2058 Siesta St. Louis, MO 63138 653-1051 (65-70)
* Rich Vie 10835 Lacklink St. Louis, MO 63114 426-2709 (71 & 74)	* Will Bowers 24 Sierra Drive Glen Carbon, IL 62034 (618) 288-4187(64-65-67)	* Dan & Deb Shabel 1576 Wooden Bridge Tr. Ballwin, MO 63021 225-1100 (67)
* Tony Bezzole 1185 Dawn Valley St. Louis, MO 63043 878-6892 (70)	Richard Barton * 18 Airwood Drive East Alton, IL 62024 (618) 259-4031 (67,69)	Harry Becker #12 Larkin Lane St. Louis, MO 63128 892-7858 (65)
* Scott Brohammer 4501 1/2 Seibert Ave St. Louis, MO 63123 631-6835 (68 CONV)	* Robert Christanell 2058 Sunflower Ct Chesterfield, MO 63017 532-7463 (65 CONV)	* Mark & Terry Clatto 9331 Fairhurst Dr Apt #C St. Louis, MO 63123 631-3518 (71)
* Thomas Dotson PO Box 854 Wentzville, MO 63385	Tom Eyssell 1763 Shuctz Road St. Louis, MO 63146 567-7843 (66)	* Ron Fiebiger 4711 Langtree Drive St. Louis, MO 63128 892-4712 (67 CONV)
John Frame 3025 College Avenue Alton, IL 62002 (618) 465-8999	Kevin Frigerio 1746 Woowind Drive Imperial, MO 63052 464-0063	* Len Greco 705 Cardinal Park Cr. Fenton, MO 63026 343-6578
* Erik Hackett 422 West Union Street Apt #5 Edwardsville, IL 62025 (618) 656-3950	Rick Herzog 1819 Page Belleville, IL 62221 (618) 234-4553 (66)	Dan Ilges 9037 Consul Avenue Affton, MO 63123 631-1565 (70)
John Johnson 620 N. Jefferson Mexico, MO 65265 581-8013 (JUDGE MAN)	Dave Kries 443 Parkside Drive Troy, IL 62294 (618) 667-4234 (NICE 68 CONV)	Joe Lay 321 Willow Point Dr St. Charles, MO 63303 441-8807

IF YOU DON'T HAVE AN ASTER BY YOUR NAME, YOU HAVE NOT PAID
YOUR 1991 MEMBERSHIP DUES. _____

*Clay & Sally Logan
417 N. Main Street
Louisiana, MO 63353
784-5953 (66)

Ray Mersch
504 Queen Ann Drive
Hazelwood, MO 63042
888-5767 (70)

*Jerry Myers
4425 Picajune
Berkeley, MO 63134
428-3350 (70 CONV)

*Steve & Tammy Hedrick
2738 Corral Estates
Arnold, MO 63010
296-7559 (67)

John Rofles
410 Timerline Ct.
Fenton, MO 63026
343-3919 (67)

*Robert Schuster
3030 Westview
Fenton, MO 63026
343-6915 (69 JUDGE)

Bryan Taylor
1125 Carla Drive
Florissant, MO 63031
881-6703

Brian Thomas
3542 Sidney Street
St. Louis, MO 63104
772-9448 (66 CONT, 67)

*Ray Maserang
1373 Greenbirch Court
Fenton, MO 63026
343-4216 (69,68 CONV)

Shelly & Dan Myer
RR # 2 - Box 497
Cedar Creek Road
Makanda, IL 62958

* Vic & Joyce Nettle
4450 Nazareth Hills
St. Louis, MO 63129
892-3639 (67 CONV, 70
70 CONV)

Kevin Porter
137 Eljon
Fenton, MO 63026
343-7064 (64)

* Bruce Rutherford
610 Marris
Lemay, MO 63125
544-5739

* John Seabolt
4141 Elkhart Lake Drive
St. Charles, MO 63303
447-7801

John Taylor, Jr.
4142 Les-Cherbourg Lane
Florissant, MO 63034
837-5808 (65)

Bob Timmerberg
1545 Keelen Drive
St. Louis, MO 63136
867-2922 (72)

* Darrell May
829 N. Metter
Columbia, IL 62236
(618) 281-5884

* Paul Midden Dorf
310 Cedar Lane
Freeburg, IL 62243
(618) 539-5954 (66)

Steven Nodiff
1342 Trails Drive
Fenton, MO 63026
677-8751 (68 CONV)

* Jerry Raglani
703 Brickingham Dr
St. Peters, MO 63376
279-2560 (64)

Terry & Dale Schott
18903 Hyway T
Glencoe, MO 63038
273-6313 (68)

* Christopher Simmons
8907 Gothrie
St. Louis, MO 63134
428-0014 (64)

Steve Thatch
102 Hampton Hts.
Festus, MO 63028
933-0390 (65,69)

Brian Vance
RT # 2 - Box 421
Troy, MO 63379
528-8306 (66)

Steven Wollmershauer 2066 St. John Avenue Highland Park, IL 60036	* Craig Weiss 15 Broadview Farm Road St. Louis, MO 63141 878-4826 (65)	* Phil Haxel 4 Wilmar Drive Quincy, IL 62301 (217) 223-9588 (68 HT-68 CONV)
* Thomas Miller 14 Teardrop Drive St. Charles, MO 63303 441-7675 (64 CPE-65 CONV)	* Dale McCurdy 2129 Bryan Drive High Ridge, MO 63049 376-8320 (70)	* Mike Kirk #5 Highridge Caseyville, IL 62232 344-5020 (Home) (818) 346-8424 (Work) (66 CONV- 69 JUDGE)
* David Bohn 6428 Judson Avenue St. Louis, MO 63123	* Bernard & Barbara Bax (Benny) RR #1 Eugene, MO 65032	Aaron Burkemper 3445 Hwy 94 North St. Charles, MO 63301 (67 TEMPEST -OHC 230)
Stan Brooks 8715 Mavis Place St. Hohn, MO 63114 428-7911 (67 HT 400)	* Thomas J. Pavlak 112 Stablestone Drive Belleville, IL 62224 (618) 233-8097 (69 JUDGE- 400 RA 111)	Ron Beach 46 Berwin Green Collinsville, IL 62234 (618) 288-5536 (65)
* Pete Fahle 11546 Springford Bridgeton, MO 63044 739-4814 (69)	Steve Anderson PO Box 178 Hematite, MO 63047 937-2927 (65) 933-0035 (Home)	Stan W. Balsman PO Box 36 Uniontown, MO 63783 788-2590 (66 CONV)
* Wayne Brewer 3512 Magnolia St. Louis, MO 63118 664-3153 (65)	* Brad Piper 19 Wilshire Drive Fairview Hts, IL 62208 (618) 398-4855 (66-67 HT)	* Paul Grabowski RR# #1 Dubois, IL 62831 (618) 787-4501 (65-67)
* Jerry Blankenship 3501 PHILO PHILO St. Louis, MO 63123 (67)	Richard S. Ward 1655 Valley Park Road Fenton, MO 63026	* Steve Lengerer 1215 Blackwatch Drive Ballwin, MO 63021
Cara Kennedy 238 Burncoate Drive St. Louis, MO 33129	Dan Mesker 2325 Bramble St. Louis, MO 63033	Larry Farley 1119 Bertch Wood Street Cedar Falls, IA 50613
* Eric Kunst 5975 N. Cuba Court St. Louis, MO 63139 781-5349 (69HT)	* MARK C Feldmann 1126 Damment St. Louis, Mo 63125 544-0730 (69 J)	

WHAT'S NEW? PONTIAC HISTORICAL SERVICE

Documentation has recently become available for a \$25.00 fee on the early, as well as, late GTO'S and Pontiacs. It consists of a copy of the build sheet (which resembles a computer punch card with numbers in various boxes) and copies of all accessory codes and dealer album data sheets. This allows you to decipher the data on the build sheet. The layout of the documentation differs slightly from year to year; however, the information on the following pages for a '67 is representative of what is available. To read, you look at the box on the card and the number in it and compare to the equipment listing. For example, box 45 contains a 4 which means the car was equipped with Rally I wheels, They are unable to provide information regarding the dealer to which the car was originally delivered. Apparently the dealer numbers changed very frequently and this type of historical information was not maintained. To obtain documentation on your car, send a check and your VIN number to: Pontiac Historical Service Co., PO Box 884, Sterling Heights, MI 48311-0884. If you are in a hurry for the information, they offer an expedited service which includes returning the information by express mail. The fee is an additional \$10.00. This could be of interest if you are in the process of buying a car. They also caution against buying a car on the basis of their documentation when it is being provided by the seller. It is very easy to cut, paste and recopy the data they provide; therefore, the documentation is only reliable when received directly from them.

HOW ABOUT A FREEBEE?

WIN A PAIR OF '67 GTO'S!

Enter the E-Z Cut Legendary Ham Sweepstakes - no purchase necessary. Print "E-Z Cut Legendary Sweepstakes" and your name, address and phone number on a 3x5 piece of paper and send to: E-Z Cut Legendary Sweepstakes, PO Box 88CY, Bridgewater, VA 22812. Entries must be received by June 30, 1991 and winners will be drawn at random. It is very important to follow the above instructions exactly. For 29 cents, it's worth a shot!

15 306 A 175H73 11 12 6 48 21 4283.70 2 4217 P 190884
 ZONE DEALER ZONE DEALER P. NO. DAY YR. TO FROM LABEL PRICE VEHICLE IDENTIFICATION NO.
 CHARGE TO SHIP TO INVOICE NO. INVOICE DATE STATE CO. MODEL YEAR TO PLT SERIAL NO.

INV. AMOUNT	E.O.M. AMT.	DEBT. AMT.	REVENUE AMT.	HOLDBACK	MISS. AMT.	TRANS. UNIT NO.	% DISC.
2	P	2	9	OX83	1W29	181091	K2 220
A/C	RAIL ALLOW	NORM. P.T.	DIST.	RTG.	TAGGED	TRK. KEY	IGN. KEY
1	4	4	3	1	5	1	2
43	44	45	46	47	48	49	50
51	52	53	54	55	56	57	58
59	60	61	62	63	64	65	66
67	68	69	70	71	72	73	74
75	76	77	78	79	80	81	82

PONTIAC MOTOR DIVISION 1967 CAR BILLING HISTORY GENERAL MOTORS CORP

CM NO.	DATE
INV NO.	DATE
CM NO.	DATE
INV NO.	DATE

07 359 | | A 184633 | 11 16 6 | 21 21 | 3784 0A | 2 B234 21 1 180884

BASIC GROUP	142-361-371-474	361	STOCK	101	MODEL YEAR	18	LOWER COLOR	UPPER COLOR OR TOP NO.	TRIM
PROTECTION GRP.	175-374-378	0421	PLATE	23					
DECOR GROUP	481-482 & DECOR MLDGB.	0841	GMAC	118					
MIRROR GROUP	291-294	0711	ODC	110					
LAMP GROUP	481-482-484	0741	TRUCK	23					
IN GRP NO.	OPTIONS & ACCESSORIES	COL.	3131314	31517112					

IN GRP NO.	OPTIONS & ACCESSORIES	COL.	3	3
331	SPRINT OPTION			
	4 Bbl. 230 Cu. Inch Overhead Cam 6 Cyl. Eng.			
	3 Speed Manual Floor Shift—Coale 733			
	Sports Type Shocks & H.D. Stabilizer Bar			
	Sprint Stripes—Coaches & Convertibles Only			
001	Radio—Pushbutton & Manual Antenna	2		
	Radio—Pushbutton & Electric Antenna—STA. HGN.	1		
	Radio—Pushbutton—AM/FM & Man. Antenna	34		
	Radio—Pushbutton—AM/FM & Elec. Ant.—STA. HGN.	3		
	Radio—Manual & Manual Antenna	3		
	Radio—Manual & Electric Antenna—EAC. STA. HGN.	3		
	Rear Seat Speaker	1		
	Verbal Phone Rear Speaker—H.A. ON STA. HGN.	35		
	Steering Tape Mat—SEAL ONLY WITH A RADIO	1		
001	Air Cleaner, Dual Stage Heavy Duty—H.A. & SPRINT	36		
	H.D. Vinyl Mat, Luggage Comp.—H.A. & HGN.	2		
001	Custom Foam Cushion—Front—STD. W. BUCKETS	1		
002	Spare Tire Cover—H.A. ON STATION WAGON	37		
002	Rear Window Defogger—H.A. ON STA. HGN. & CONV.	1		
002	Rear Window Wind Deflector—STA. HGN. ONLY	3		
002	Door Edge Guards	38		
001	Mirror, Visor Vanity	1		
001	Mirror, Outside Remote Control	39		
001	Lamp, Luggage—H.A. ON STATION WAGON	1		
001	Lamp, Glove Box	40		
001	Lamp, Roof Rail & Resting—EAC. CONV.	1		
001	Lamp, Courtesy—STD. ON CONV.	1		
001	Lamp, Ash Tray & Lighter	41		
001	Lamp, Underhood	1		
001	Lamp, Ignition & Starter Switch	42		
001	Seat Belts, Custom—FRONT & REAR	1		
	Seat Belt, Rear Center	43		
	Shoulder Belts, Front Seat	1		
	Door Control—H.A. & STD. ONLY	1		
	Integrated Speedometer—H.A. WITH MG	44		
	Rally Gauge Cluster & Tachometer—H.A. WITH MG	1		
	Wire Wheel Discs	2		
	Rally 11 Wheels	45		
	Rally 1 Wheelie	1		
	Custom Wheel Discs	3		
001	Deluxe Wheel Discs	46		
001	Deluxe Steering Wheel	1		
	Custom Sports Steering Wheel	47		
	Console—ORDER WITH BUCKET SEATS ONLY	1		
001	Clock, Electric—H.A. WITH MG	1		
	Dual Exhaust—H.A. ON ONLY—STD. ON HGN.	48		
	Exhaust Extension—H.A. ON DUAL EXHAUSTS OR SPRINT ONLY	1		
	Delete Mirrors	1		
	Deck Lid Release, Remote Control—H.A. ON STA. HGN.	49		
	Dual Floor	1		
	Power Steering	1		
	Power Brakes—INCLUDES PEDAL FROM P&G	50		
	Tilt Steering Wheel—H.A. & STD. STEERING	1		
	Custom Carpets	51		
	Luggage Carrier—STATION WAGON ONLY	1		
	H.D. Blade Fan & Fan Clutch—H.A. ONLY—STD. W. HGN.	1		
	Dual Brakes, Front—INCLUDES POWER BRAKES	52		
	Red Plastic Center Luggage—H.A. & STA. HGN.	1		
	Custom Floor Mat & Mat—MANUAL TRANS. ONLY	1		
	Glass Soft Ray—ALL WINDOWS	53		
	Glass Soft Ray—WINDSHIELD ONLY	1		
	Power Window—Station Wagon Tail Gate	54		
	Power Top	1		
	Power Windows	55		
	Power Seat—Bench	56		
	Power Seat—Bucket—H.A. ONLY	1		
	Head Rest—L.H. & R.H.—BUCKET SEATS ONLY	1		
	Head Rest—L.H. & R.H.—BENCH SEAT ONLY	57		
	Reclining Seat—R.H. Bucket Only—INCLUDES IN	1		
	Custom Air Conditioning	58		
	Delete Heater—EXCEPT W. AIR CONDITIONING	1		
	Ride & Handling Pkg.—SPRINT—SHOCKS & STABILIZER BAR	52		
0621	Floor Mats—FRONT & REAR	1		
	Floor Mats—FRONT ONLY	63		
	Super-Lift Shock Absorbers—REAR ONLY	1		
	Luggage Discharge Function—H.A. & STA. HGN.	67		
	Battery—H.D.—STD. WITH AIR COND. OR ENG. & STD.	1		
	FREE OPTIONS	1015		
	7:55 x 14 White	128		
	7:55 x 14 Red Line	121		
	8:10 x 14 Red—White Oval—H.A. & STA. HGN. & CONV.	121		
	8:10 x 14 White—White Oval—H.A. & STA. HGN. & CONV.	121		
	AXLES	COL.		
	Rate-T-Track Rear Axle	1		
	Economy Axle Ratio	73		
	Performance Axle Ratio	81		
	TRANSMISSIONS			
	Turbo Hydra-Matic—STD. ONLY	78		
	Automatic	78		
	3 Speed Man.—Fully Synchronized—3.0L SHIF. EXC.	78		
	4 Speed Man.—Fully Synchronized—H.A. & STA. HGN.	78		
	H.D. 4 Wheel Man.—Fully Synchronized—FLOOR SHIF.—H.A. ONLY	78		
	ENGINES			
	1 Barrel V-6—110 Cubic Inch—REG. FUEL—STD. ENG.	30		
	2 Barrel V-6—125 Cubic Inch—REG. FUEL	30		
	HO-4 Barrel V-6—125 Cubic Inch—PREM. FUEL—STA. HGN.	30		
	2 Barrel V-6—100 Cubic Inch—REG. FUEL—STD. ONLY	30		
	HO-4 Barrel V-6—100 Cubic Inch—PREM. FUEL	30		



PONTIAC

PONTIAC DIVISION
General Motors Corporation
One Pontiac Plaza
Pontiac, Michigan 48340-2952

November 8, 1990

Dear Pontiac Enthusiast:

We would like to introduce Pontiac Historic Services to you. This independent firm has been authorized by Pontiac Division to fill the increasing demand for historic information from Pontiac owners, restorers, collectors, enthusiasts and buffs who are looking for specific information on their Pontiac. Pontiac Historic Services is comprised of Pontiac enthusiasts who are extremely knowledgeable and capable of handling your requests.

Over the past few years, it has become increasingly difficult for Pontiac Division to fill these requests on a timely basis. And, as the requests for information became more detailed, it also became a costly process. That is why we have turned to Pontiac Historic Services which will perform this service for 1981-model and older Pontiacs. (Information requests for post-1981 models will continue to be handled on a no-cost basis by the Pontiac Customer Assistance Center -- 1-800-762-2737).

By supplying Pontiac Historic Services with the complete VIN number, along with the other information listed below, you will receive most complete historical background and VIN information ever offered by any automobile nameplate.

The information packet from Pontiac Historic Services will include:

- A copy of the factory invoice or billing history.
- A letter decoding the options (where necessary).
- A copy of a dealer order form for that year.
- An official photo for that year Pontiac, if available.
- Other specific information for that year and model Pontiac, if available.

Pontiac Historic Services will charge \$25 per vehicle to be researched. If you wish to obtain this information, please complete the attached form and mail it with a check or money order payable to Pontiac Historic Services and mail to:

Pontiac Historic Services
P.O. Box 884
Sterling Heights, MI 48311-0884

Of course, Pontiac Public Relations will continue to answer general questions about our current or past models. If you seek additional information that you feel should not be handled by Pontiac Historic Services, please contact me or any other member of the Pontiac Public Relations Staff.

Regards

Ed Lechtzin
Director
Public Relations Staff

[]



PONTIAC
HISTORIC SERVICES

P.O. Box 884 • Sterling Heights, MI 48311-0884

To order your VIN and Information Packet, please return the attached order form, along with a \$25 check or money order payable to:

Pontiac Historic Services
P.O. Box 884
Sterling Hts, Mi, 48311-0884

The information packet from Pontiac Historic Services will include:

- A copy of the factory invoice or billing history.
- A letter decoding the options (where necessary).
- A copy of a dealer order form for that year.
- An official photo for that year Pontiac (if available).
- Other specific information for that year and model Pontiac (if available).

Customer Name _____

Street Address _____

City _____ State _____ Zip _____

VEHICLE INFORMATION

Year _____ Model _____

Complete VIN _____

Notes _____

Gateway GTO Association Ads



CARBURETOR RESTORATIONS

Sales/Resto. Service

Specializing in Pontiac Tripowers
Guaranteed Show Quality
Repro Parts Available

Buy/Sell/Trade - Pontiac Parts • Services
Buying Tripowers - Complete/Parts

DARRELL CARNAL
(314) 928-8030

1458 Arapahoe Way
St. Charles, MO 63303

Carburetor Restoration: Tri-powers and Quadrajets rebuilt, recolored and relplated. Special discounts for Gateway GTO Association members. For sale: 65 Tri-power, restored, includes intake and carburetors with fuel lines, \$650. Other units also available for sale. Darrell Carnal (314)928-8030

L & S Cores: If you are looking for Pontiac engines, heads or cranks, for the best price in town call Luke Smith (314)383-1111

For Sale: 1970 GTO, Jade Green with green interior, 400, Automatic, Air, P/S, P/B, Very Clean! Call Dan Ilges (314)631-1565

Wanted: '65-'67 GTO hood in good condition. Call Darrell Carnal (314)928-8030

Wanted: Pair of 1970 GTO doors and a deck lid. Must be in very good to excellent condition. Call Tony Bezzole (314)878-6892

Wanted: 1967 GTO RH fender, rust free; 1967 four speed stabilizer bars for rear end; 1966-67 posi rear end. Call Dan Shabel (314)225-1100

Wanted: 1970 GTO or LeMans seat bottom, any color, must be perfect, John Novelli 653-1051

Wanted: 1967 GTO parts; gas tank, complete wood wheel, manual antenna, fan shroud (non A/C). Call Brad Piper (618)398-4855

TREASURER'S REPORT

Beginning Balance.....\$464.11

Expenses:

 Pizza Party.....\$180.27

 Printing.....\$ 7.00

Total After Expenses.....\$276.84

Deposits.....\$373.50

Ending Balance.....\$650.34

There was a drawing at the meeting on 2/3/91.
The four winners were:

 Chris Simmons.....\$9.50
 Steve Hedrick.....Jacket
 Paul Middendorf.....Jacket
 Mark Feldman.....Jacket

New Members: Mark Feldman
 Eric Kunst
 Steve Lengerer

Gateway GTO Association Accessories for sale:

 Gateway GTO Assoc. Iron-on Transfers
 Hooded Sweatshirts
 T-Shirts,
 Beerwraps

If anyone is interested in ordering a jacket,
please call Earl Chapman 282-2203. So far three
people want jackets and the minimum order is
twelve.

So far, 44 members have paid their membership
dues. This is a great start for the year.
Members who have not paid are encouraged to do
so.

APPLICATION FORM

Send Completed Application to:
GTO Association of America, Inc.
1634 Briarson Drive
Saginaw, MI 48603

 New Renewal

Name _____

Address _____

City _____ State _____

Zip _____ Country _____

Telephone (____) - _____

Names of family members for whom Associate
Membership dues are enclosed:

List GTO Ownership

Year	Body Style	Engine Size
_____	_____	_____
_____	_____	_____
_____	_____	_____
_____	_____	_____

I agree that, if elected to membership, I will conform to all
rules of the Association and conduct myself in a manner that
promotes the goals and purposes of the Organization.

Signed _____

Please check method of payment:

Check Money Order Mastercard Visa

Card # _____

Expiration Date _____

Interbank # (Mastercard) _____

NOTE: A \$2.00 bank processing fee will be added for cards.

Signature _____

Renewals Only:

GTO Association Membership # _____

Gateway GTO Association Membership Application
(Please print clearly)

Name: _____

Associate Name: _____

Address: _____

City, State, Zip _____

Home Phone: () _____ Work Phone: () _____

Occupation: _____

Year & Body Style of Car(s) _____

Auto related interest, hobbies or talents: _____

If you are a current member of the GTO Association of America please list your membership #: _____

Send completed membership application along with a check payable to the Gateway GTO Association to:

Earl Chapman, Treasurer
Gateway GTO Association
5000 Country Ridge Dr.
Imperial, MO 63052

Membership dues are \$18.00 per year, which includes you and an associate member (spouse, girlfriend, etc.). All dues are required to be paid in January. Dues for new members are pro-rated \$1.50 per month if they join after January.

Gateway GTO Association
c/o Tony Bezzole
1185 Dawn Valley Dr.
St. Louis, MO 63043

